

F-1001M_J-C

MODULAR CUBELET ICE MACHINE

SLIM-LINE SERIES

Item # _____

Project: _____

Qty: _____

*AutoCad available on KCL

F-1001M_J-C

10/14

Item #13107

FLAKER DIMENSIONS

W x D x H

F-1001M_J-C

22 x 27^{3/8} x 25^{15/16}



B-300



B-500



B-700

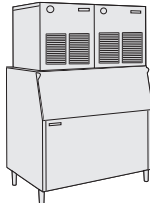

B-800

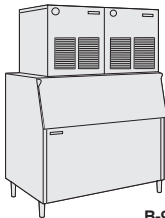

B-900

Also available on Large Bins:

B-1150SS
B-1300SS
B-1500SS
B-1650SS

*CUBELET DIMENSIONS

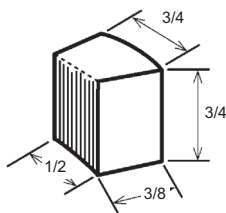

*approximate size, image not to scale



F-1001MAJ-C

Air-Cooled

Shown on an optional
B-700

F-1001MWJ-C

Water-Cooled

F-1001MRJ-C

Remote Air-Cooled

- Up to 910 lbs. of ice production per 24 hours
- Durable stainless steel exterior
- Protected by H-GUARD Plus Antimicrobial Agent
- Advanced CleanCycle24™ Design
- Produces ideal chewable ice
- Longer life and easy maintenance
- R-404A Refrigerant



ISO 9001-ISO 14001



AISI CERTIFIED
Advanced Commercial Ice Makers
and Freezers



UL CERTIFIED
SA10203

Warranty

Valid in United States, Canada, Puerto Rico, & U.S. Territories. Contact factory for warranty in other countries.

Three Year - Parts & Labor on entire machine.

Five Year - Parts on Compressor, air-cooled condenser coil.



HOSHIZAKI

F-100IM J-C CUBELET ICE MACHINE SLIM-LINE MODULAR SERIES

DIMENSIONS
W x D x H
F-100IM J-C
22 x 27^{3/8} x 25^{15/16}

- Air-cooled
- Water-cooled
- Remote Air-cooled

AIR-COOLED

Water Temp ° F.	50°	70°	90°
Air Temp ° F.	70°	80°	90°
70°	910	869	832
80°	797	764	731
90°	700	656	643

WATER-COOLED

Water Temp ° F.	50°	70°	90°
Air Temp ° F.	70°	80°	90°
70°	790	788	770
80°	751	734	717
90°	700	703	667

REMOTE AIR-COOLED

Water Temp ° F.	50°	70°	90°
Air Temp ° F.	70°	80°	90°
70°	840	825	797
80°	771	745	720
90°	696	683	650

UTILITY CONSUMPTION

Model Number	KWH per 100 LBS.		Potable Water Gal. per 100 lbs.		Condenser Water Gal. per 100 lbs.	
	90/70	70/50	90/70	70/50	90/70	70/50
F-1001MAJ-C	5.3	3.9	12.0	12.0	N/A	N/A
F-1001MWJ-C	4.1	3.8	12.0	12.0	130	61
F-1001MRJ-C	5.3	4.6	12.0	12.0	N/A	N/A

SPECIFICATIONS

Model Number	Condenser	Amperage	Min. Circuit Ampacity	Shipping Weight
F-1001MAJ-C	Air-Cooled	15.2	20	210 lbs.
F-1001MWJ-C	Water-Cooled	14.2	20	210 lbs.
F-1001MRJ-C	Remote Air-Cooled	15.7	20	210 lbs.

STORAGE BINS

Model Number	Application Capacity	ARI-Rated Capacity
B-300	300 lbs.	260 lbs.
B-500	500 lbs.	360 lbs.
B-700	700 lbs.	550 lbs.
B-800	800 lbs.	600 lbs.
B-900	900 lbs.	660 lbs.
B-1150	1150 lbs.	N/A
B-1300	1275 lbs.	N/A
B-1500	1490 lbs.	N/A
B-1650	1605 lbs.	N/A

ELECTRICAL & PLUMBING/F-100IM J-C

- I 15V/60/1
- Icemaker Water Supply Line: Minimum 1/4" Nominal ID Copper Water Tubing or Equivalent
- Icemaker Drain Line: Minimum 3/4" Nominal ID Hard Pipe or Equivalent



© HOSHIZAKI AMERICA, INC.

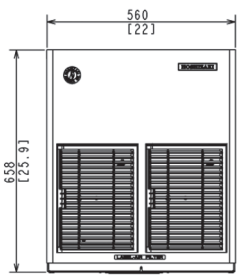

FRONT VIEW (Air)

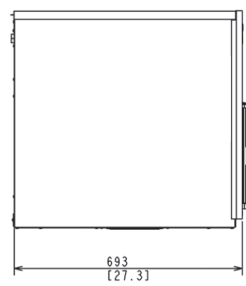

SIDE VIEW

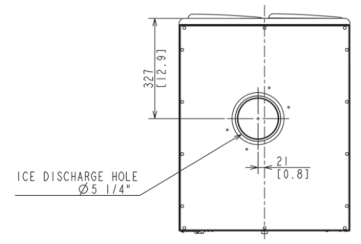

ICE DROP ZONE

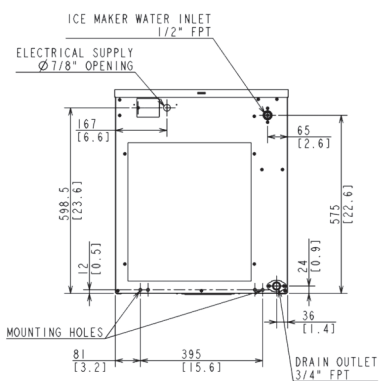

AIR-COOLED UNIT

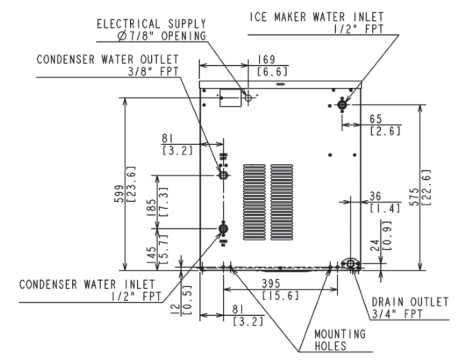

WATER-COOLED UNIT

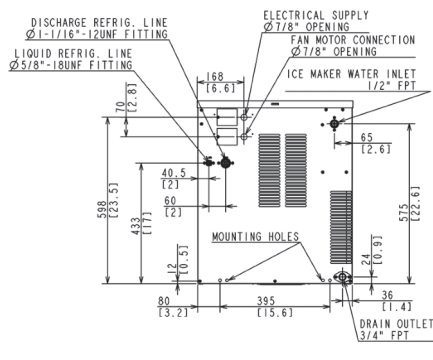

REMOTE AIR-COOLED UNIT

URC-5F Remote Condenser (Sold Separately)
For Use with F-1001MRJ

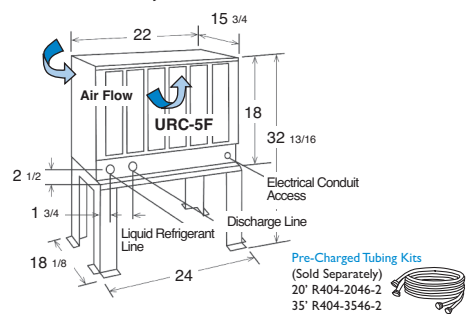

Voltage supply for the URC Remote Condenser is supplied from the Ice Maker. No additional circuit is required.

OPERATING LIMITS

- Ambient Temp Range 45 - 100° F
- Water Temp Range 45 - 90° F
- Water Pressure 10 - 113psig
- Voltage Range 104 - 127V

SERVICE

- Panels easily removed and all components accessible for service.
- Removable/cleanable air filter. (Air-Cooled model only)

OPERATING LIMITS/URC-5F

- Ambient Temp Range -20° F - +122° F
- Voltage Range 104 - 127V

